

## The spot where a fort once stood

IT doesn't look much now, but once there was an Iron Age fort on this spot at Mowsbury Camp, Bedford.

Mr. Gerald Dring, a micro-biologist at Unilever, Sharnbrook, who is in charge of the dig, has unearthed a cobbled circle, which is the possible base of an Iron Age hut circle.

With him in the centre of the picture are a party of first-year history students from Bedford College of Education, and one of their lecturers, Mr. Philip Liddle, who is by the fence.

In the background another group are standing where a 12-foot high rampart defended the site. Beyond that was a ditch.

In the distance can be seen Mowsbury Park.

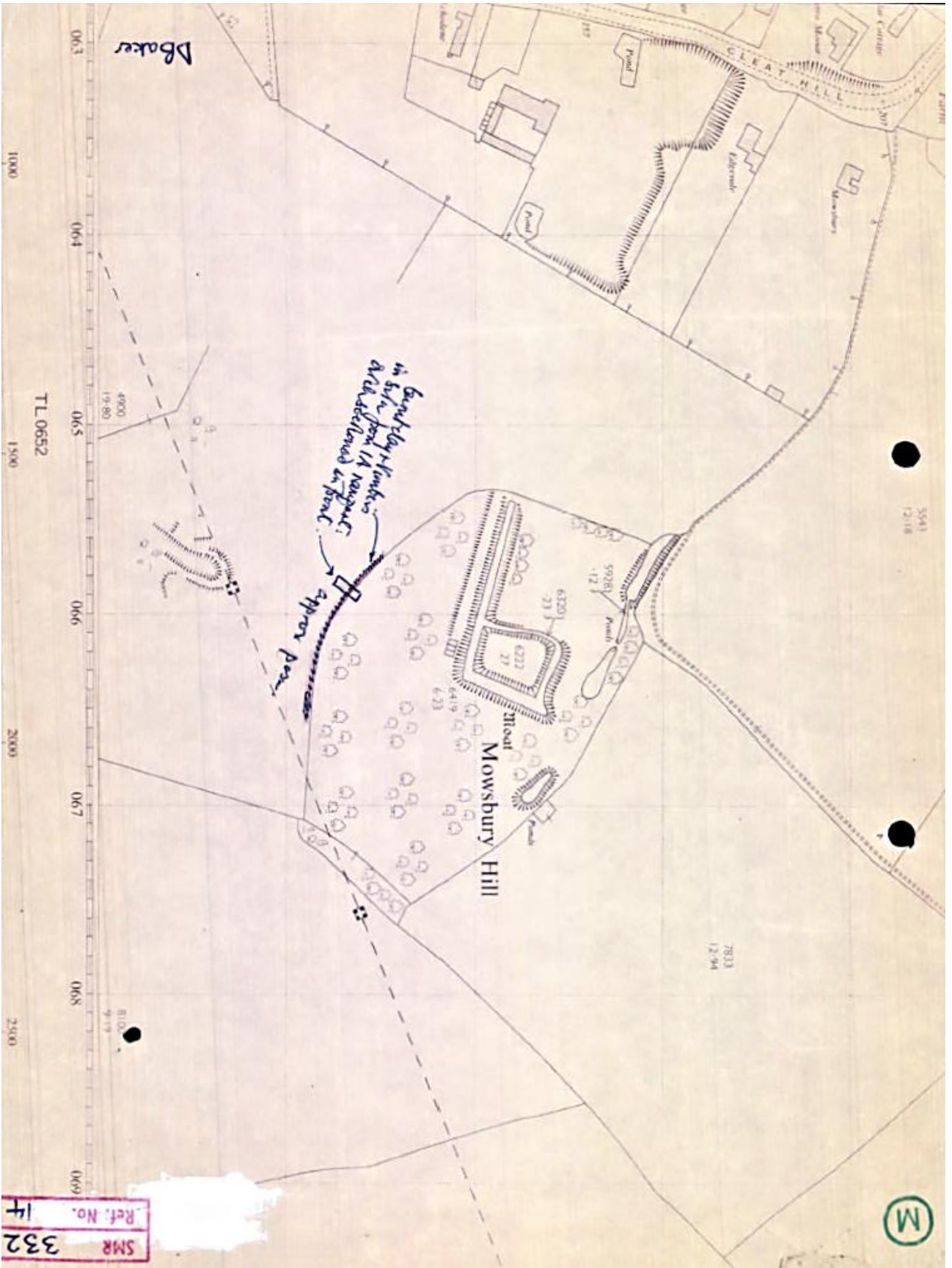

SMR 332  
Ref. No. 15

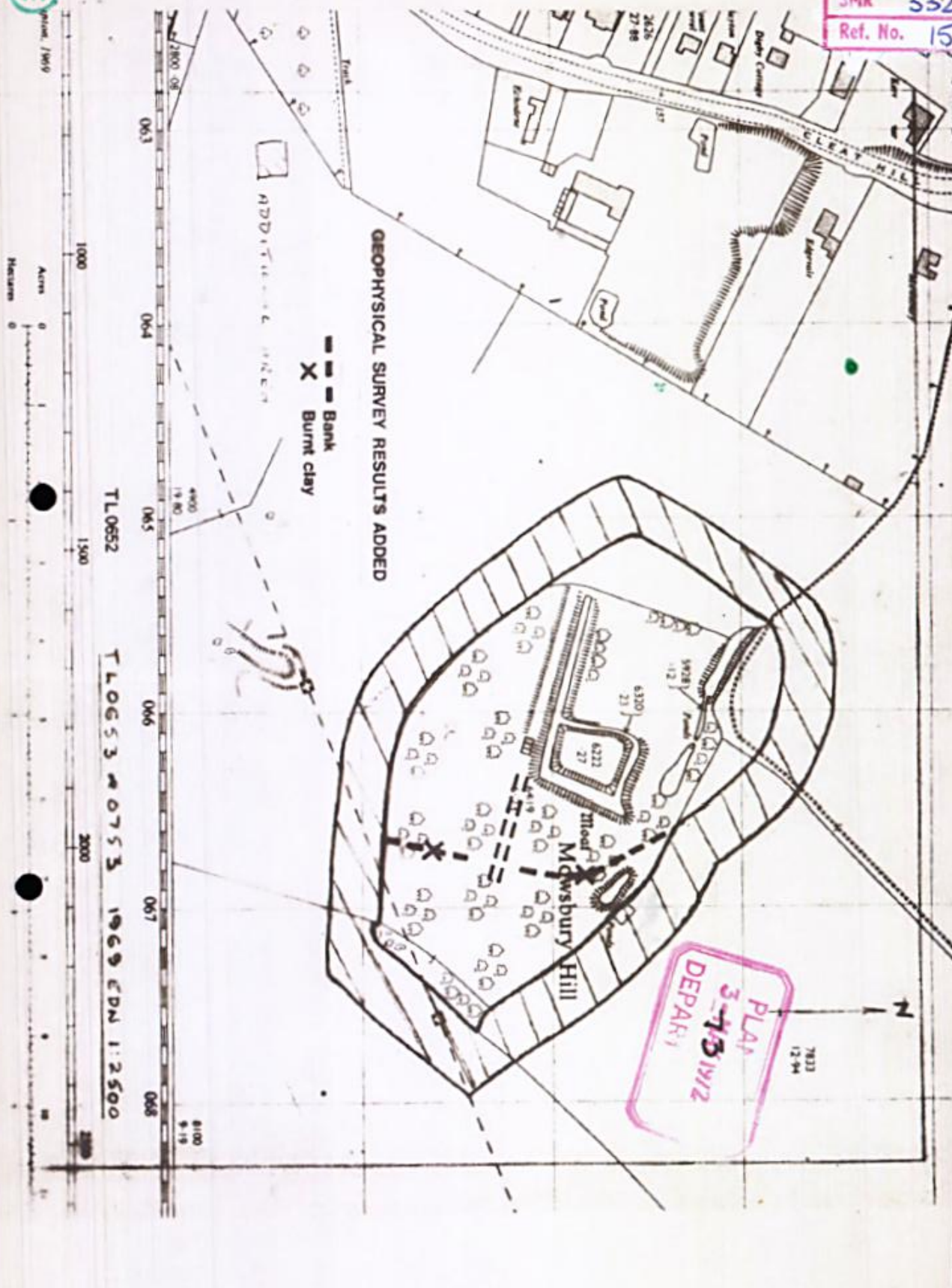

GEOPHYSICAL SURVEY RESULTS ADDED

Bank  
X Burnt clay

TL0652

TL0653 #0753 1969 CPD 1:2500

Acres  
Meters

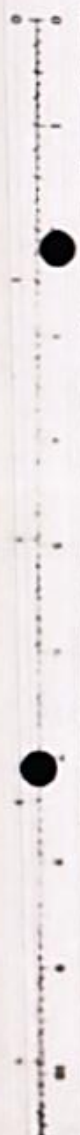

PLAN 3-13/12  
DEPAR 1

7823  
12-94

Mewsbury Hill

CLEAY HILL

ADDITIONAL INTEREST

Fence

2100 08

063

064

065

066

067

068

8100  
5-19

1500

2000

2500

6300

5825

5222

5222

5222

5222

5222

5222

5222

5222

5222

5222

5222

6300

5825

5222

5222

5222

5222

5222

5222

5222

5222

5222

5222

5222



© Crown copyright and database rights 2014 Ordnance Survey 100049028. You are not permitted to copy, sub-license, distribute or sell any of this data to third parties in any form.

**Mowsbury Hillfort**  
**1968 Detail**





Mowsbury Hillfort  
1968

0 100 Meters



**BEDFORD**  
BOROUGH COUNCIL

© Crown copyright and database rights 2014 Ordnance Survey 100049028. You are not permitted to copy, sub-license, distribute or sell any of this data to third parties in any form.



Mowbury Hillfort  
RAF Aerials (1940s and 50s)

0  
100 Meters

